

ASME/ANSI Standard Freedom Series® PT-Type Roller Chain

Freedom Series® Self-Lubricating Roller Chains offer premium performance and value in a sintered bushing maintenance free product. These chains feature the addition of rollers to reduce friction and smooth the action over sprockets, specially coated pins and link plates for rust prevention and special part treatments for improved wear performance. The PT-Type chains are used mainly for power transmission applications. Side plates of the roller links are one size thicker than standard providing chain strength that is similar to standard roller chains. This allows for direct replacement for most moderate speed drive applications. The chains will operate on standard ASME/ANSI sprockets.

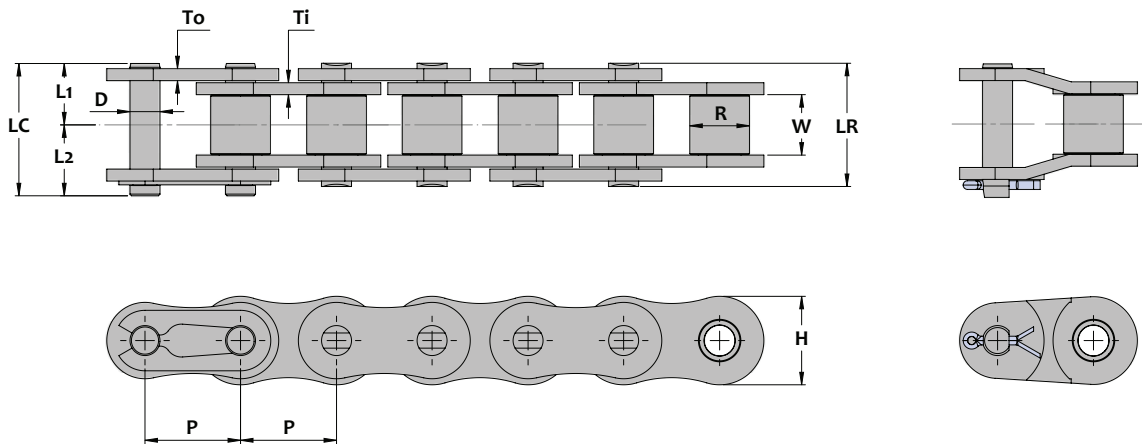

Chain Dimensions

SENQCIA Chain Number	Units	Chain Pitch P	Roller		Dia D	Pin				Side Plate			Average Ultimate Strength Lbs Kg-f	Rated Working Load Lbs Kg-f	Average Chain Weight Lbs/ft Kg/m
			Dia. R	Inside Width W		Length L1	Length L2	Length LR	Length LC	Height H	Thickness				
											Ti	To			
40FS	inch	0.500	0.312	0.313	0.156	0.33	0.39	0.65	0.71	0.461	0.080	0.060	4,300	815	0.47
	mm	12.70	7.92	7.95	3.96	8.3	9.8	16.6	18.1	11.7	2.0	1.5	1,955	370	0.70
50FS	inch	0.625	0.400	0.375	0.200	0.41	0.47	0.81	0.88	0.575	0.094	0.080	7,200	1,410	0.74
	mm	15.875	10.16	9.53	5.08	10.3	12.0	20.6	22.3	14.6	2.4	2.0	3,275	641	1.10
60FS	inch	0.750	0.469	0.500	0.234	0.51	0.57	1.02	1.08	0.689	0.125	0.094	10,000	1,940	1.14
	mm	19.05	11.91	12.70	5.95	13.0	14.5	26.0	27.5	17.5	3.2	2.4	4,545	882	1.70
80FS	inch	1.000	0.625	0.625	0.312	0.65	0.76	1.30	1.41	0.921	0.157	0.126	17,650	3,300	1.81
	mm	25.4	15.88	15.88	7.93	16.5	19.4	33.0	35.9	23.4	4.0	3.2	8,025	1,500	2.70
100FS	inch	1.250	0.75	0.750	0.375	0.78	0.91	1.57	1.70	1.154	0.189	0.157	26,500	5,080	2.88
	mm	31.75	19.05	19.05	9.53	19.9	23.2	39.8	43.1	29.3	4.8	4.0	12,045	2,310	4.30
120FS	inch	1.500	0.875	1.000	0.437	0.98	1.11	1.96	2.09	1.382	0.220	0.188	39,000	6,830	4.02
	mm	38.10	22.23	25.40	11.10	24.9	28.3	49.8	53.2	35.1	5.6	4.8	17,725	3,105	6.00

ASME/ANSI Standard Freedom Series® C-Type Roller Chain

Freedom Series® Self-Lubricating C-Type chains are dimensionally equivalent to standard products. Available in single strand, double strand. These chains can be used for power transmission or conveyor applications that utilize attachments. Double Pitch chains are also available. C-Type chains are stronger than SL-Series but not as strong as PT-Type so care must be taken to assure the chains possess sufficient strength when replacing standard carbon steel chains.

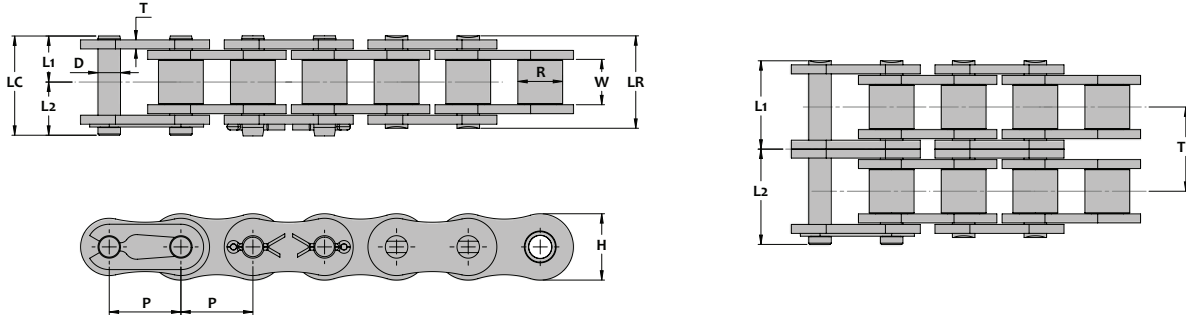

Chain Dimensions - Single Strand

SENQCIA Chain Number	Units	Chain Pitch P	Roller			Pin				Side Plate		Trans. Pitch TP	Average Ultimate Strength Lbs Kg-f	Rated Working Load Lbs Kg-f	Average Chain Weight Lbs/ft Kg/m
			Dia. R	Inside Width W	Dia. D	Length			Height H	Thick. T					
						L1	L2	LR			LC				
40FS-C	inch	0.500	0.312	0.313	0.156	0.33	0.38	0.65	0.70	0.461	0.060	-	3,530	815	0.40
	mm	12.70	7.92	7.95	3.96	8.3	9.6	16.6	17.9	11.7	1.5	-	1,605	370	0.60
50FS-C	inch	0.625	0.400	0.375	0.200	0.40	0.46	0.80	0.87	0.575	0.080	-	5,730	1,410	0.67
	mm	15.875	10.16	9.53	5.08	10.2	11.8	20.4	22.0	14.6	2.0	-	2,605	641	1.00
60FS-C	inch	0.750	0.469	0.500	0.234	0.50	0.56	1.00	1.06	0.689	0.094	-	8,390	1,940	1.01
	mm	19.05	11.91	12.70	5.95	12.8	14.1	25.5	26.9	17.5	2.4	-	3,815	882	1.50
80FS-C	inch	1.000	0.625	0.625	0.312	0.65	0.75	1.29	1.40	0.921	0.126	-	14,320	3,310	1.68
	mm	25.4	15.88	15.88	7.93	16.4	19.1	32.8	35.5	23.4	3.2	-	6,510	1,505	2.50
100FS-C	inch	1.250	0.75	0.750	0.375	0.78	0.92	1.55	1.69	1.154	0.157	-	22,480	5,060	2.62
	mm	31.75	19.05	19.05	9.53	19.7	23.3	39.4	43.0	29.3	4.0	-	10,220	2,300	3.90
120FS-C	inch	1.500	0.875	1.000	0.437	0.98	1.13	1.95	2.10	1.382	0.188	-	35,300	6,830	3.89
	mm	38.10	22.23	25.40	11.10	24.8	28.6	49.5	53.4	35.1	4.8	-	16,045	3,105	5.80

Chain Dimensions - Double Strand

40-2FS-C	inch	0.500	0.312	0.313	0.156	0.61	0.66	1.21	1.27	0.461	0.060	0.567	7,060	1,420	0.74
	mm	12.70	7.92	7.95	3.96	15.4	16.8	30.8	32.2	11.7	1.5	14.4	3,210	645	1.10
50-2FS-C	inch	0.625	0.400	0.375	0.200	0.76	0.82	1.51	1.57	0.575	0.080	0.712	11,470	2,380	1.27
	mm	15.875	10.16	9.53	5.08	19.2	20.8	38.4	40.0	14.6	2.0	18.08	5,215	1,080	1.90
60-2FS-C	inch	0.750	0.469	0.500	0.234	0.94	1.01	1.90	1.96	0.689	0.094	0.898	12,280	3,400	1.88
	mm	19.05	11.91	12.70	5.95	24.0	25.7	48.2	49.7	17.5	2.4	22.8	5,580	1,545	2.80
80-2FS-C	inch	1.000	0.625	0.625	0.312	1.21	1.33	2.43	2.54	0.921	0.126	1.154	28,550	5,780	3.29
	mm	25.4	15.88	15.88	7.93	30.8	33.7	61.6	64.5	23.4	3.2	29.3	12,975	2,625	4.90

ISO 606B British Standard Freedom Series® C-Type Roller Chain

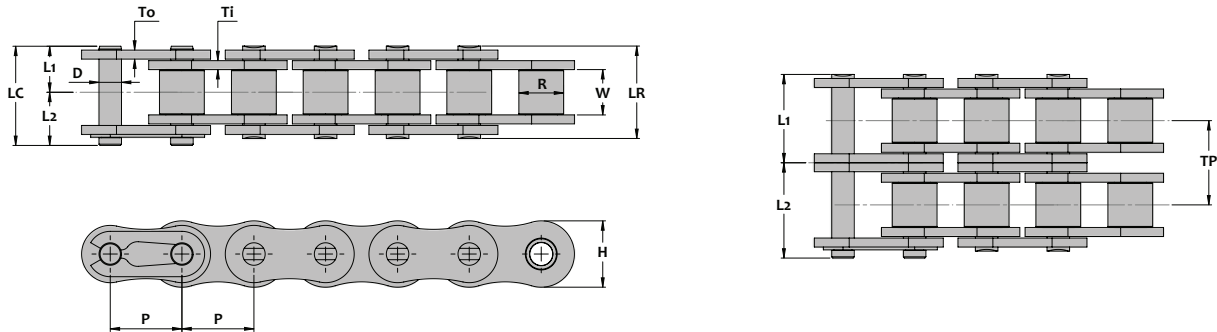

Chain Dimensions - Single Strand

SENQCIA Chain Number	Units	Chain Pitch P	Roller			Pin				Side Plate			Trans. Pitch TP	Average Ultimate Strength Lbs Kg-f	Rated Working Load Lbs Kg-f	Average Chain Weight Lbs/ft Kg/m
			Inside Width W	Dia. R	Dia. D	Length				Height H	Thickness					
						L1	L2	LR	LC	To	Ti					
08BFS-C	inch	0.500	0.305	0.335	0.175	0.33	0.39	0.66	0.72	0.465	0.060		-	3,780	650	0.40
	mm	12.70	7.75	8.51	4.45	8.4	9.8	16.7	18.2	11.8	1.5		-	1,720	295	0.60
10BFS-C	inch	0.625	0.380	0.400	0.200	0.37	0.44	0.75	0.81	0.579	0.065		-	5,530	990	0.60
	mm	15.875	9.65	10.16	5.08	9.5	11.2	19.0	20.7	14.7	1.65		-	2,515	450	0.90
12BFS-C	inch	0.750	0.460	0.475	0.225	0.43	0.50	0.87	0.93	0.634	0.070		-	7,280	1,420	0.74
	mm	19.05	11.68	12.07	5.7	11.0	12.6	22.0	23.6	16.1	1.8		-	3,310	645	1.10
16BFS-C	inch	1.000	0.670	0.625	0.325	0.69	0.81	1.38	1.50	0.827	0.126	0.157	-	16,770	2,740	1.74
	mm	25.40	17.02	15.88	8.26	17.6	20.6	35.1	38.2	21.0	3.2	4.0	-	7,625	1,245	2.60
20BFS-C	inch	1.250	0.770	0.750	0.400	0.79	0.94	1.58	1.73	1.039	0.138	0.177	-	28,840	4,290	2.55
	mm	31.75	19.56	19.05	10.16	20.1	23.9	40.2	44.0	26.4	3.5	4.5	-	13,110	1,950	3.80

Chain Dimensions - Double Strand

08B-2FS-C	inch	0.500	0.305	0.335	0.175	0.60	0.65	1.20	1.26	0.465	0.060		0.548	7,550	1,120	0.87
	mm	12.70	7.75	8.51	4.45	15.3	16.6	30.6	31.9	11.8	1.5		13.92	3,430	509	1.30
10B-2FS-C	inch	0.625	0.380	0.400	0.200	0.70	0.77	1.40	1.47	0.579	0.065		0.653	11,060	1,690	1.21
	mm	15.875	9.65	10.16	5.08	17.8	19.5	35.6	37.3	14.7	1.65		16.59	5,025	768	1.80
12B-2FS-C	inch	0.750	0.460	0.475	0.225	0.82	0.88	1.64	1.70	0.634	0.070		0.766	14,570	2,430	1.94
	mm	19.05	11.68	12.07	5.7	20.8	22.3	41.6	43.1	16.1	1.8		19.46	6,625	1,105	2.90
16B-2FS-c	inch	1.000	0.670	0.625	0.325	1.32	1.44	2.64	2.76	0.827	0.126	0.157	1.255	33,540	4,650	3.42
	mm	25.40	17.02	15.88	8.26	33.6	36.5	67.2	70.1	21.0	3.2	4.0	31.88	15,245	2,115	5.10
20B-2FS-C	inch	1.250	0.770	0.750	0.400	1.51	1.66	3.02	3.17	1.039	0.138	0.177	1.435	57,690	7,280	4.90
	mm	31.75	19.56	19.05	10.16	38.4	42.2	76.8	80.6	26.4	3.5	4.5	36.45	26,225	3,310	7.30

ASME/ANSI Double Pitch Freedom Series® C-Type Roller Chain

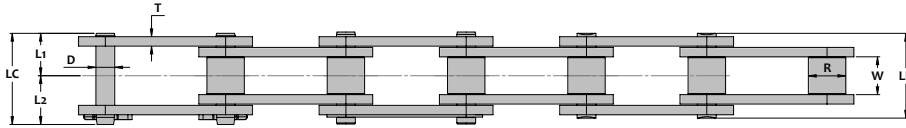

Standard Roller

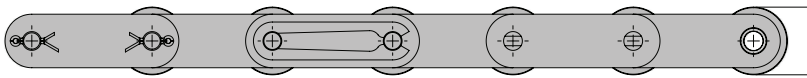
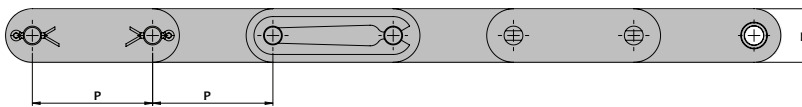

Large Roller

Chain Dimensions - Standard Roller

SENQCIA Chain Number	Units	Chain Pitch P	Roller		Dia D	Pin				Side Plate		Average Ultimate Strength Lbs Kg-f	Rated Working Load Lbs Kg-f	Average Chain Weight Lbs/ft Kg/m
			Dia R	Inside Width W		Length L1	Length L2	Length LR	Length LC	Height H	Thick. T			
C2040FS-C	inch	1.000	0.312	0.313	0.156	0.32	0.41	0.65	0.73	0.475	0.060	3,530	595	0.34
	mm	25.40	7.92	7.95	3.96	8.2	10.3	16.4	18.5	12.06	1.5	1,605	270	0.50
C2050FS-C	inch	1.250	0.400	0.375	0.200	0.40	0.49	0.80	0.89	0.594	0.080	5,730	970	0.54
	mm	31.75	10.16	9.53	5.08	10.2	12.4	20.3	22.6	15.1	2.0	2,605	441	0.80
C2060HFS-C	inch	1.500	0.469	0.500	0.234	0.57	0.67	1.13	1.23	0.712	0.125	8,390	1,410	0.94
	mm	38.10	11.91	12.70	5.95	14.4	16.9	28.8	31.3	18.1	3.2	3,815	641	1.40
C2080HFS-C	inch	2.000	0.625	0.625	0.312	0.71	0.89	1.43	1.60	0.950	0.156	14,320	2,410	1.61
	mm	50.80	15.88	15.88	7.93	18.2	22.6	36.3	40.7	24.1	4.0	6,510	1,095	2.40

Chain Dimensions - Larger Roller

C2042FS-C	inch	1.000	0.625	0.313	0.156	0.32	0.41	0.65	0.73	0.475	0.060	3,530	595	0.67
	mm	25.40	15.88	7.95	3.96	8.2	10.3	16.4	18.5	12.06	1.5	1,605	270	1.00
C2052FS-C	inch	1.250	0.750	0.375	0.200	0.40	0.49	0.80	0.89	0.594	0.080	5,730	970	1.07
	mm	31.75	19.05	9.53	5.08	10.2	12.4	20.3	22.6	15.1	2.0	2,605	441	1.60
C2062HFS-C	inch	1.500	0.875	0.500	0.234	0.57	0.67	1.13	1.23	0.712	0.125	8,390	1,410	1.88
	mm	38.10	22.23	12.70	5.95	14.4	16.9	28.8	31.3	18.1	3.2	3,815	641	2.80
C2082HFS-C	inch	2.000	1.125	0.625	0.312	0.71	0.89	1.43	1.60	0.950	0.156	14,320	2,410	3.08
	mm	50.80	28.58	15.88	7.93	18.2	22.6	36.3	40.7	24.1	4.0	6,510	1,095	4.6