

MoraviaŘetězy

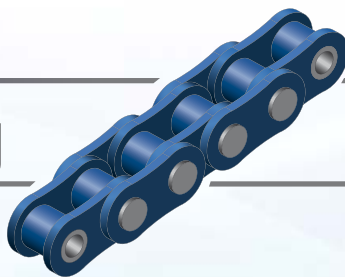

# Chain Drives

*Conveyor chains*

# Conveyor chains – the heart of our production

Chain manufacturing is the core of our production. We manufacture and supply a comprehensive range of standard conveyor chains but also pay attention to customer requirements and special chain designs.

Modern technology is used during the manufacturing process, which improves the quality of our chains at each production step. Conveyor chains are made of steel with the option of surface finishing (usually zinc coating), or are of stainless steel.



## Basic production series

- Conveyor chains M - series (DIN 8167)
- Conveyor chains FV - series (DIN 8165)

The basic series consist of a solid pin and straight side plates. Other designs include:

- Hollow pin chains
- Deep link chains
- Scraper chains

## Special production series

- BS Series (British Standard 4116/4)
- SMS Series (Swedish Old Standard 1698)
- Gall chains DG (DIN 8150)
- Transmission chains (DIN 8164)
- Production of special conveyor chains (non-standard design) according to customer specifications

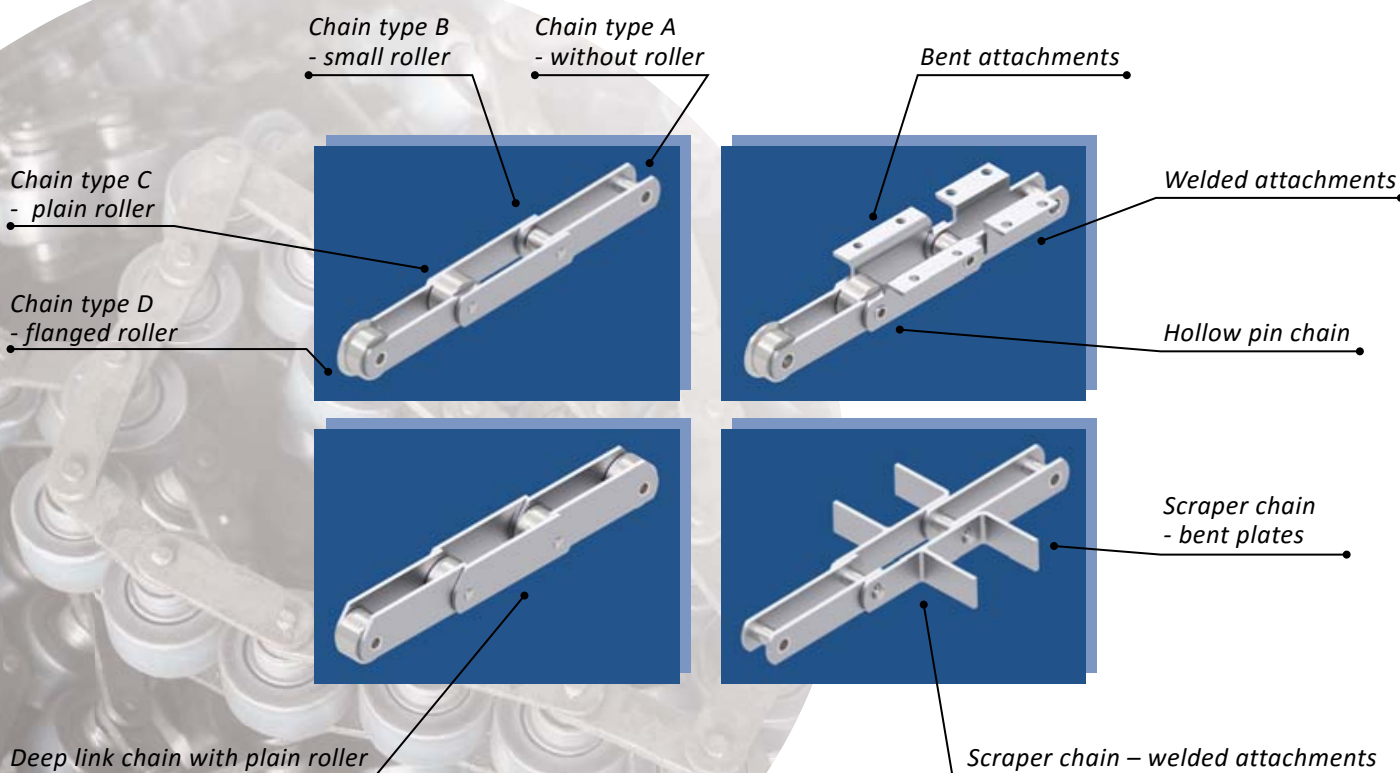

# Sprockets for Conveyor chains

High-precision special sprockets (chainwheels) are provided for all chains. Sprockets are manufactured mostly from steel (option of induction hardening or sprocket teeth tempering), or stainless steel and other suitable materials may be used.

We offer several sprockets with hubs:

- Sprocket and hub made from one piece
- Sprocket with welded-on hub

Hub designs:

- Single-sided or double-sided
- With technological hole, precision hole with groove for a tongue, tapered hole, etc.

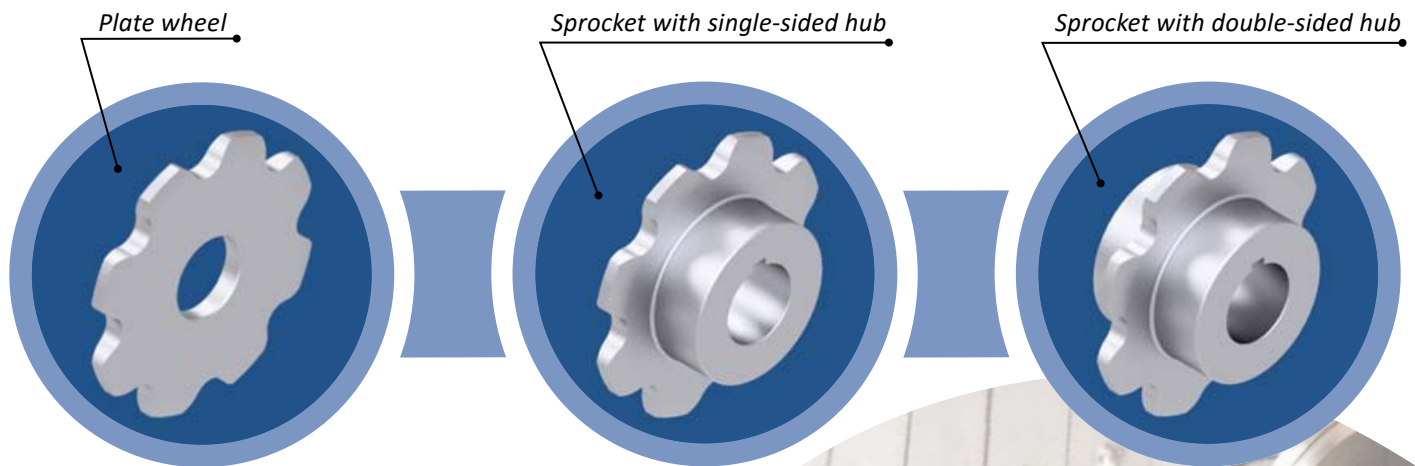

## Technology

- Plated pins and bushings to prevent pins from slipping and bushings on chain plates
- Mechanical cleaning of chain components (chain plates) using a blasting machine
- Hardening or tempering of rotating components (pins, bushings, rollers)
- Component welding
- Pins are round riveted
- Other designs used to secure pins in place - cotter pins, circlips or welded pins
- Chain lubrication carried out on a special cleaning and oiling



**Moravia**Řetězy

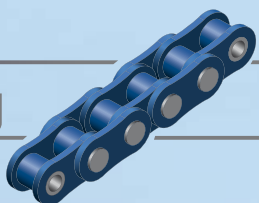

## Contact:

**MORAVIA ŘETĚZY a.s.**

Hulínská 1799/1 (Magnetron a.s. premises)

CZ - 767 01 Kroměříž

Czech republic

**Tel:** +420 573 334 106

**Fax:** +420 573 330 556

**e-mail:** sales@moravia-retezy.cz

**www.moravia-retezy.cz**

**www.moravia-retezy.cz**